

REV	REV / DATE	ENG APP/DATE	MFG APP/DATE	REVISIONS
A				ORIGINAL DRAWING

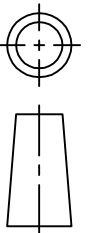
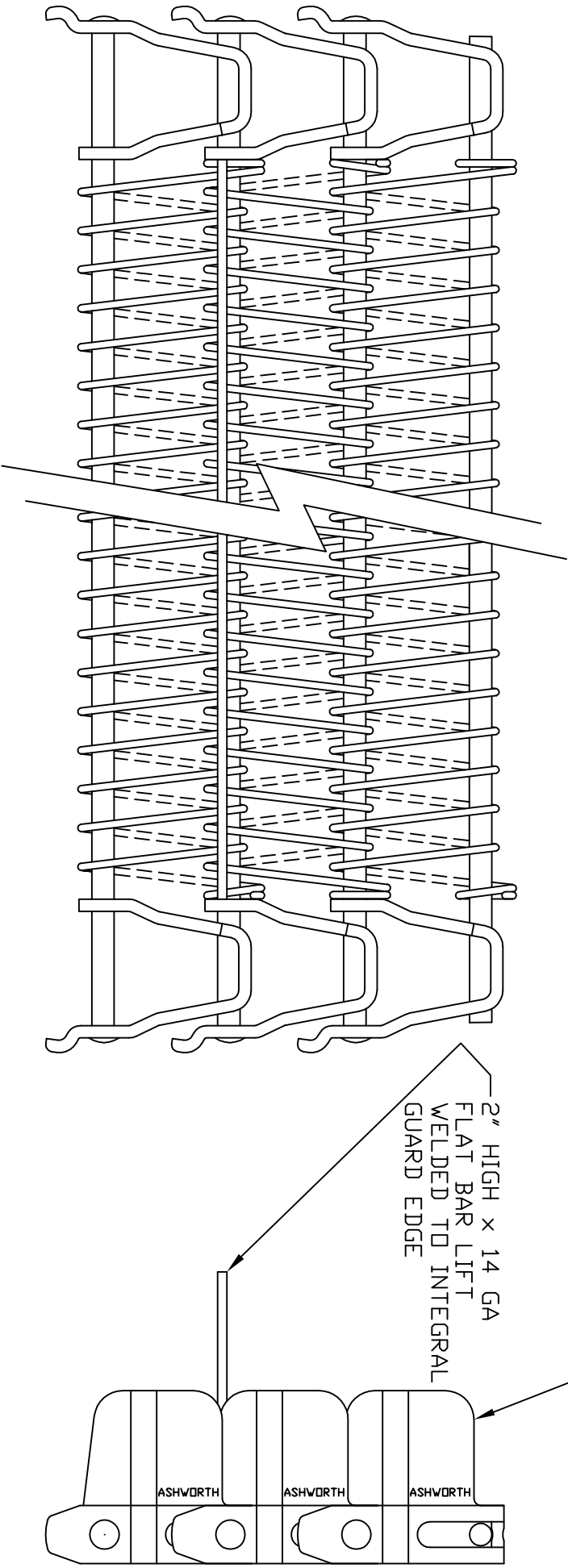

DIMENSIONS IN INCHES [mm]

TOLERANCE UNLESS OTHERWISE SPECIFIED

INCHES	EQUIV mm	FRACTION INCHES EQUIV mm	ANGLE ±1/2°
DEC .X	[0.8]		
.XX	[0.38]	±1/16 [1.6]	
.XXX ±.005	[0.13]		
.XXXX±.0005	[0.013]		

SCALE DNS

DRAWN / DATE

JB 11/12/09

ENG APP / DATE

JB 11/12/09

MANU APP / DATE

N/A



ASHWORTH BROS., INC.
BELT DIVISION
450 ARMOUR DALE, WINCHESTER, VA 22604

ILLUSTRATION

1' P OMNI-PRD 100 w/ INTEGRAL GE LINKS BOTH SIDES EVERY PITCH
B36-12-16 D-T MESH w/ 2" HIGH FLAT BAR LIFT BAR LIFT WELD TO INTEGRAL GE LINK

THIS DRAWING CONTAINS CONFIDENTIAL INFORMATION AND TRADE SECRETS OF ASHWORTH BROS., INC. IT MAY NOT BE REPRODUCED IN WHOLE OR IN PART, OR USED FOR THE BENEFIT OF ANYONE OTHER THAN ASHWORTH BROS., INC. NO RIGHT IS GRANTED TO DISCLOSE OR USE ANY INFORMATION SHOWN ON THIS DRAWING

DRAWING NUMBER

29 A 4415

REV

A