

REVISION HISTORY			
REV	DESCRIPTION	DATE	APPROVED
A	ORIGINAL DRAWING		

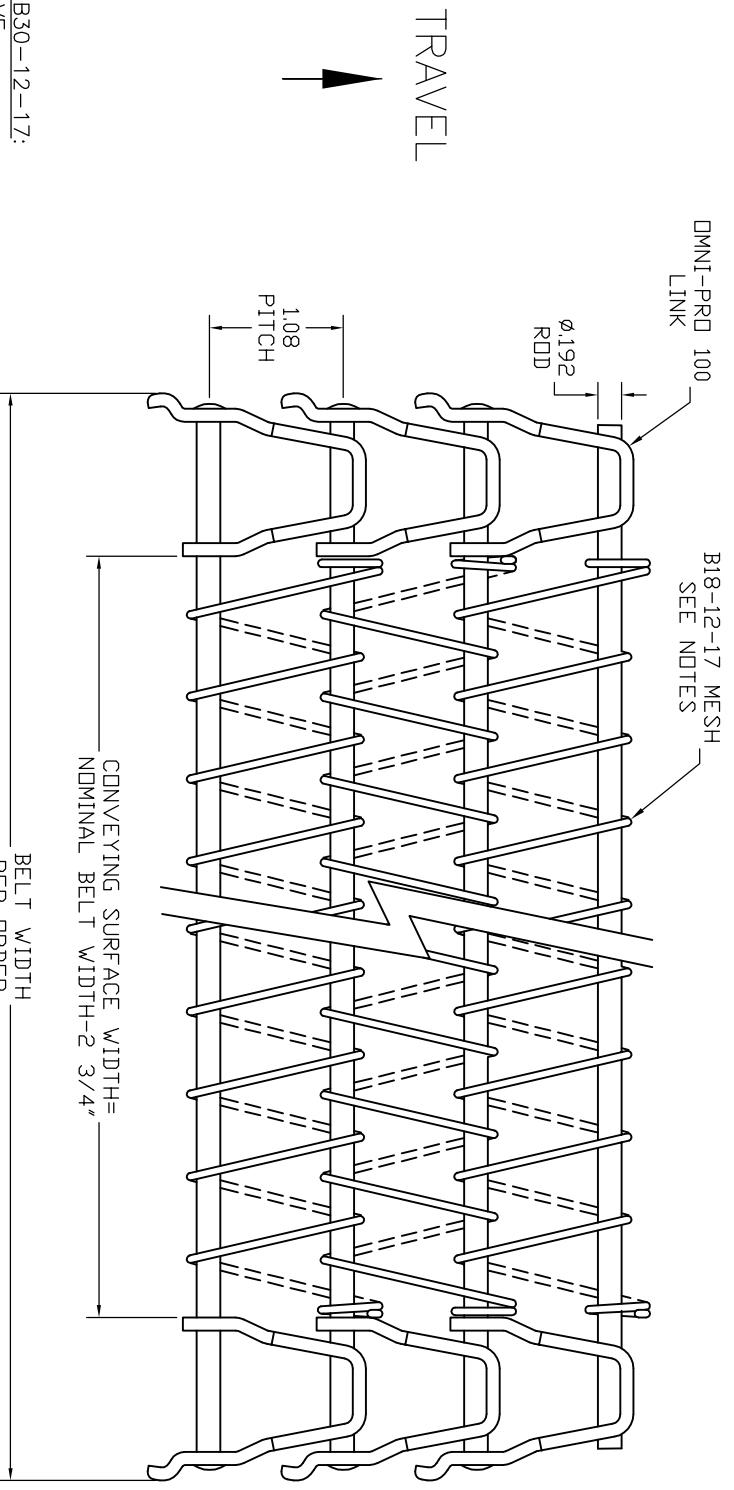

TRAVEL



MESH DESIGNATION B30-12-17:  
 B = BALANCED WEAVE  
 18 = LATERAL (WIDTH) MESH PITCH = 18 LOOPS PER FOOT (NOMINAL)  
 12 = LONGITUDINAL (LENGTH) MESH PITCH = 12 PITCHES PER FOOT (NOMINAL)  
 17 = MESH WIRE GAGE =  $\phi.054$ "

**UNCONTROLLED COPY**  
 FOR MANUFACTURE OR PURCHASE

UNLESS OTHERWISE SPECIFIED DIMENSIONS ARE IN INCHES	TOLERANCES
DEC .X = $\pm .03$	FRACTION $\pm 1/16$
.XX = $\pm .015$	ANGLE $\pm 1/2^\circ$
.XXX = $\pm .005$	
.XXXX = $\pm .0005$	
THIRD ANGLE PROJECTION	

THIS DRAWING CONTAINS CONFIDENTIAL INFORMATION AND TRADE SECRETS OF ASHWORTH BROS., INC. IT MAY NOT BE REPRODUCED IN WHOLE OR IN PART, OR USED FOR THE BENEFIT OF ANYONE OTHER THAN ASHWORTH BROS., INC. NO RIGHT IS GRANTED TO DISCLOSE OR USE ANY INFORMATION SHOWN ON THIS DRAWING

DRAWN/DATE  
 NEC 5/29/09

CHECKED/DATE  
 --

ORIGINATOR/DATE  
 NEC 5/29/09

CONTRACT NO  
 --

**Ashworth**  
 ASHWORTH BROS., INC.  
 BELT DIVISION  
 450 ARMOUR DALE, WINCHESTER, VA 22601

ILLUSTRATION  
 OMNI-PRO 100, B18-12-17 MESH

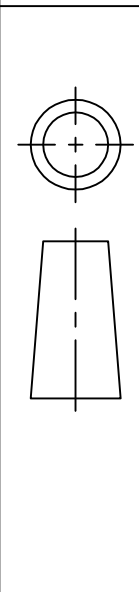

SIZE	CAGE CODE	DWG NO	REV
A		29-4400	A
SCALE	WEIGHT	SHEET	
NTS	--	1 OF 1	

TITLE	OMNI-PRO 100, B18-12-17 MESH
-------	------------------------------